

Tolerance grade	Unmarked tolerance						
	0.5-3	3-6	6-30	30-120	120-400	400-1000	1000-3000
Precision F	±0.05	±0.05	±0.1	±0.2	±0.3	±0.3	±0.5
Medium M	±0.1	±0.1	±0.2	±0.3	±0.5	±0.8	±1.2
Coarse C	±0.2	±0.3	±0.5	±0.8	±1.2	±2	±3

3.2

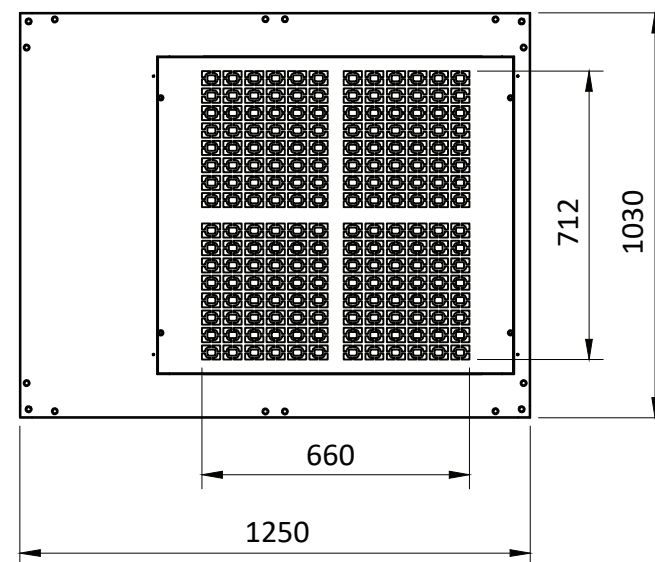
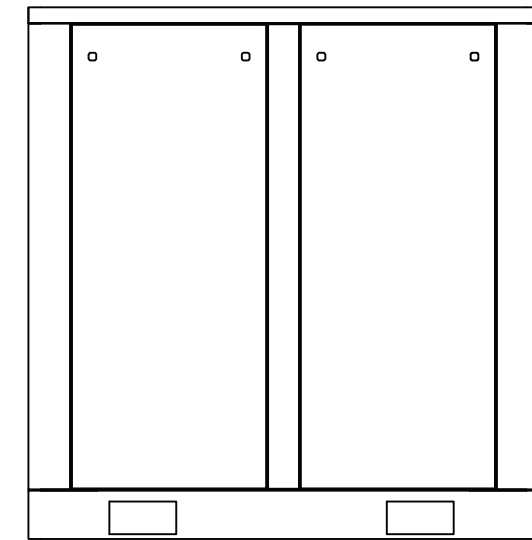
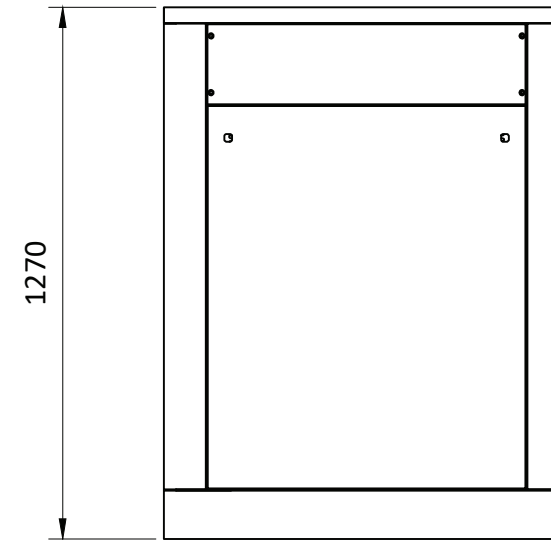
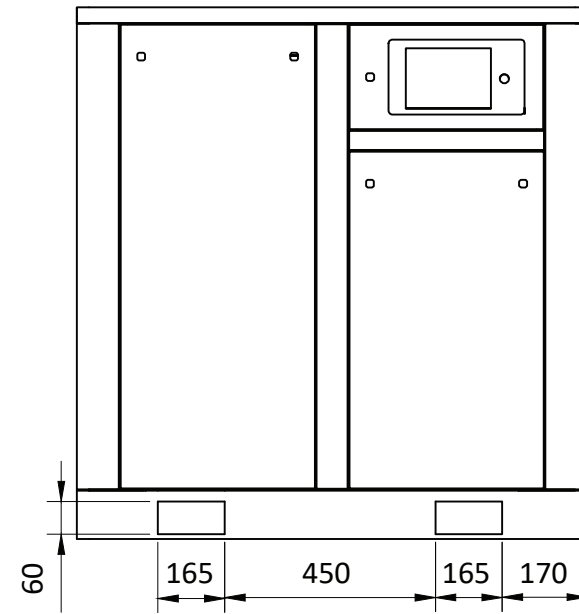
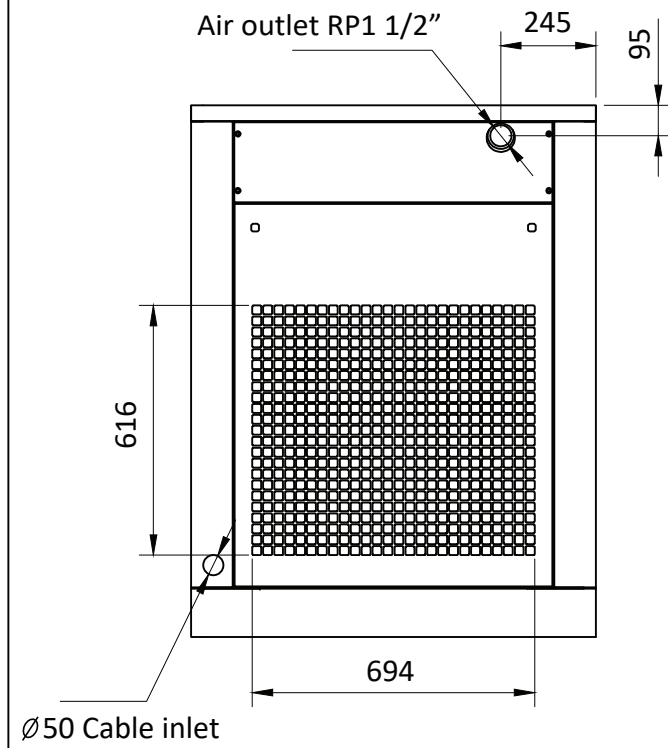

Technical requirements:

1. All dimensional tolerance:  $\pm 3\text{mm}$
2. The reserved length of the power cable not less than 1m
3. The space of surrounding of air compressor should reserve at least 1m, and the space in front of the air compressor controller should reserve at least 1.5m
4. No force or torque shall be generated to the compressor after install the external pipelines
5. Do not use plastic pipes in downstream pipelines
6. After the compressor is installed, seal the forklift hole with the cover plate
7. When installing the exhaust pipe of the compressor, the pressure loss should be less than 0,0006 bar
8. Power supply please follow the data in nameplate, must connect the ground wire.